

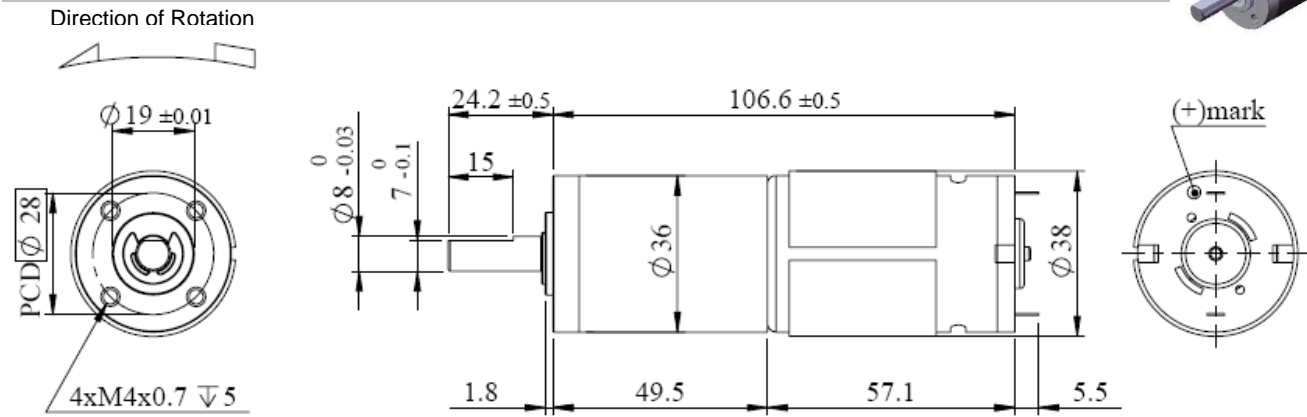

# PK36K5SP Series of DC Planetary Gear Motor



## Appearance Dimensions:



unit:

## Typical Performance Curves :

PK36K5SPN284-272 (12V)

PK36K5SP960-272 (24V)

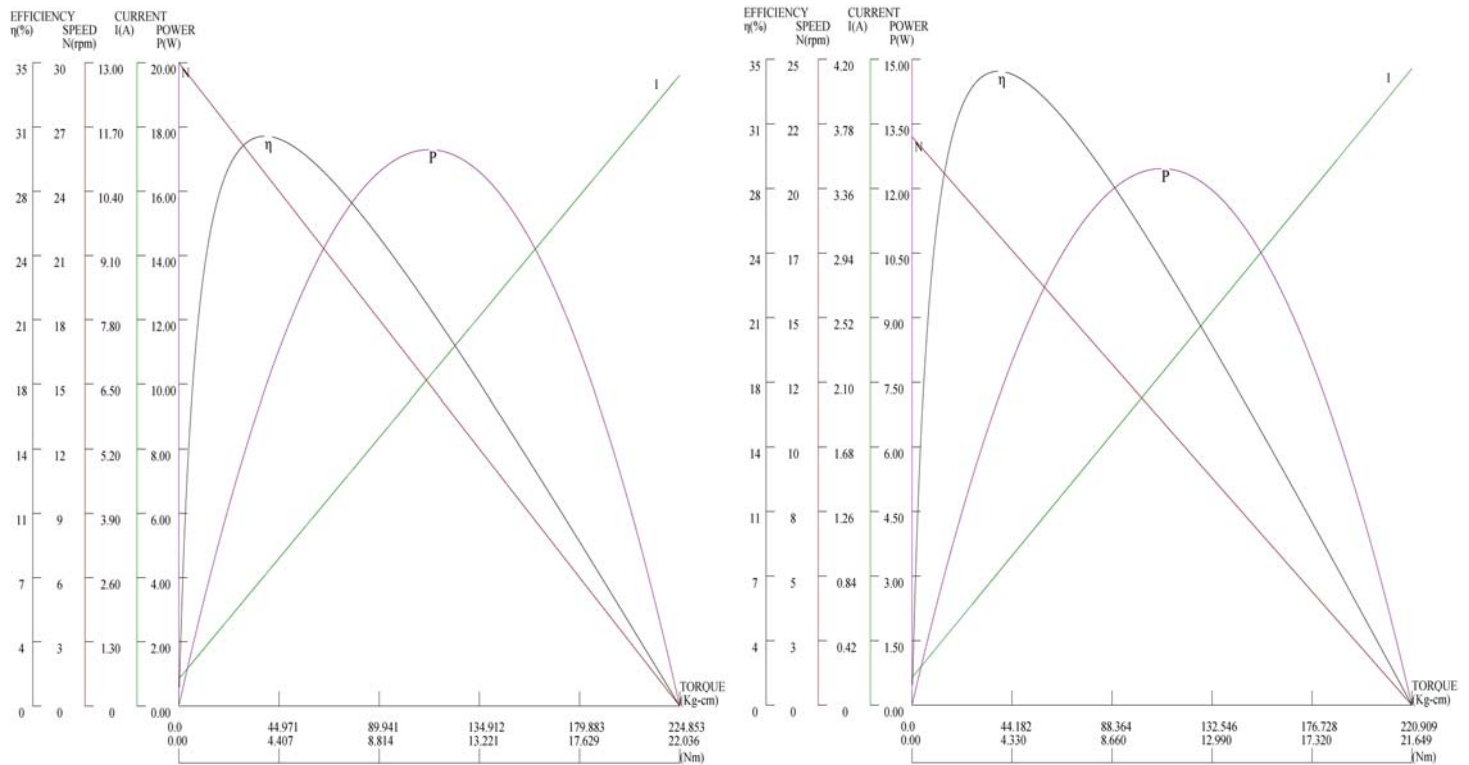

## Standard DC Gear Motor Specifications:

## Gearbox Specifications:

Model	Rated Voltage	Reduction Ratio	1/272
0284	12V	No Load Speed(rpm)	30
		No Load Current (mA)	550
		Rated Torque (kg-cm)	25.00
		Rated Speed (rpm)	26.5
		Rated Current (mA)	1900
		0960	24V
No Load Current (mA)	180		
Rated Torque (kg-cm)	25.00		
Rated Speed (rpm)	19.5		
Rated Current (mA)	650		

Gearbox Type	Planetary
Gear Material	Mixed
Reduction Ratio	1/272
Gearbox Length (L)	49.50
Rated Torque (kg-cm)	25.00
Max.Momentary Torque (kg-cm)	75.00
Efficiency (%)	50.00
Radial Play of Shaft (mm)	0.04
Thrust Play of Shaft (mm)	0.30
Output Shaft Axial Load (kg)	3.00
Output Shaft Radial Load (kg)	8.00

## Notes:

The specifications may change or update without notice since the product improvement.